

SYMBOLS - POWER

WALL	DESCRIPTION
	DUPLEX RECEPTACLE - 20A, MTD. 18" (460 MM) AFF UNLESS OTHERWISE NOTED. SUBSCRIPT "GFI" INDICATES GROUND FAULT TYPE. "N" INDICATES NOT HOSPITAL GRADE. "ST" INDICATES (ISA) SAFETY TYPE. AND "I" INDICATES ISOLATED GROUND (IF USED).
	QUAD RECEPTACLE - 20A, MTD. 18" (460 MM) AFF UNLESS OTHERWISE NOTED. SUBSCRIPT "GFI" INDICATES GROUND FAULT TYPE. "N" INDICATES NOT HOSPITAL GRADE. "ST" INDICATES SAFETY TYPE. AND "I" INDICATES ISOLATED GROUND (IF USED).
	SPECIAL PURPOSE OUTLET, SEE EQUIPMENT SCHEDULE AND MATCH TO FINAL EQUIPMENT SELECTIONS. MTD. 18" AFF UNLESS OTHERWISE NOTED.
	THERMOSTAT
	BRANCH OR FEEDER CIRCUIT HOMERUN TO PANELBOARD, SWITCHBOARD, MOTOR CONTROL CENTER, ETC. SUBSCRIPT DENOTES PANELBOARD, SWITCHBOARD, MOTOR CONTROL CENTER, ETC. AND OVERCURRENT PROTECTION DEVICE NUMBER.
	WIRING SYSTEM BELOW FLOOR OR BELOW GRADE.
	WIRING SYSTEM EXPOSED.
	JUNCTION OR PULL BOX. W = WEATHERPROOF.
	NON-FUSIBLE SAFETY SWITCH. NUMERAL INDICATES AMPERE RATING.
	PANELBOARD FLUSH MOUNTED. TOP 6'-6" AFF.
	PANELBOARD SURFACE MOUNTED. TOP 6'-6" AFF.

SYMBOLS - DATA/TELEPHONE
& LOW VOLTAGE

WALL	DESCRIPTION
	TELEPHONE/DATA OUTLET, MTD. 18" (460 MM) A.F.F. U.N.O.. - PROVIDE BLANK BACK BOX W/ PULL STRING & TERMINATION FITTING TERMINATE ABOVE CEILING INSIDE.
SYMBOLS - SWITCHES	
WALL	DESCRIPTION
S	NOTE: MOUNTING HEIGHT FOR THE FOLLOWING SWITCHES SHALL BE 48" (1100 MM) AFF: IN ELECTRICAL CLOSET, MECHANICAL ROOMS, MOUNTING HEIGHT SHALL BE 4'-6" AFF.
S ₃	SINGLE POLE SWITCH WITH SUFFIX A.B.C. ETC. INDICATES CONTROL OF FIXTURE(S) WITH SAME DESIGNATION(S).
S ₃	THREE-WAY SWITCH.
S _D	DIMMER CONTROL SWITCH

- KEYED ELECTRICAL NOTES
1. REMOVE RECEPTACLE. RELOCATE EXISTING CIRCUIT TO NEW LOCATION
 2. REUSE EXISTING CIRCUIT, CHANGE TO GFI
 3. PROVIDE SINGLE GANG BACKBOX, WITH 1" CONDUIT, PLACED 6" ABOVE FINISHED CEILING. OWNER TO PROVIDE CABELING
 4. PROVIDE JUNCTION BOX & 24V STEPDOWN TRANSFORMER FOR UNDER CABINET LIGHTING ABOVE CEILING. ROUTE 24V WIRING THROUGH SWITCH AS SHOWN.
 5. EXISTING LIGHTING IN ROOM TO REMAIN
 6. EXISTING DATA BOX TO BE REMOVED
 7. 208 OUTLET

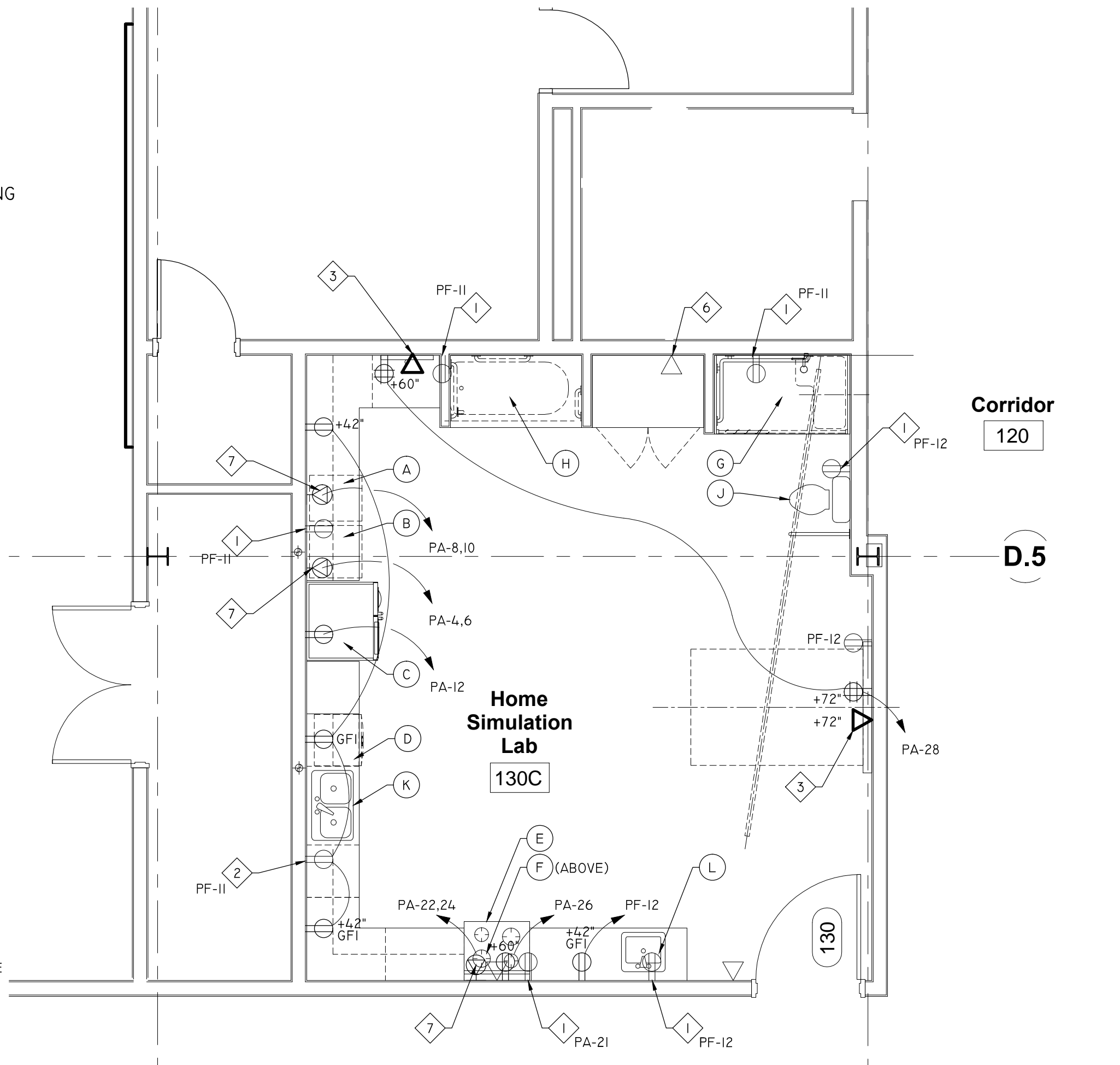

1 ELECTRICAL PLAN - POWER & DATA
SCALE: 1/4" = 1'-0"

HOME CARE LAB EQUIPMENT/FIXTURE SCHEDULE			DIMS. (IN)			ELECTRIC				PLUMBING			
ITEM/DESCRIPTION	MANUFACTURER	MODEL NO.	W	D	H	VOLTS	PH.	HZ.	AMP	HOT	COLD	WASTE	VENT
A 24" COMPACT CONDENSATION DRYER	BOSCH	WTG864-00UC	23.5	25.0	33.3	208	1	60	13				
B 24" COMPACT WASHER	BOSH	WAT284-00UC	23.5	24.3	33.3	208	1	60	12				
C REFRIGERATOR	WHIRLPOOL	WRS57ICIDIM				120	1	60	6	1/4"			1/4" LINE FROM SINK. W/ WATTS 909 INLINE BACKFLOW
D DISHWASHER	WHIRLPOOL	WD7780SAEM				120	1	60	4	1/2"		3/4"	WATER & DRAIN TO ADJACENT SINK
E ELECTRIC STOVE	WHIRLPOOL	WEE745H0FS				208	1	60	50				
F MICROWAVE	WHIRLPOOL	WMH53520CS				120	1	60	8				
G ADA SHOWER	LIBERTY	11623634RSADA	60.0	36.0	78.0								DEMONSTRATION ONLY NO PLUMBING
H ADA TUB	LIBERTY	116033LADA	60.0	33.0	77.0								DEMONSTRATION ONLY NO PLUMBING
J TOILET	KOHLER	HIGHLINE											DEMONSTRATION ONLY NO PLUMBING
K DOUBLE SINK	JUST	DLN-17537-A-GR	37.0	17.5	18.0					1/2"	1/2"	2"	1 1/2" FAUCET: MOEN 7594E WITH AC ADAPTER, 1.5 GPM, ANGLE STOP + MCGUIRE 2165. P-TRAP: MCGUIRE 8912I W/ ESCUTCHEON
L SINGLE SINK - ADA	ELKAY	ELUHA0211555	16.0	21.0	6.5					1/2"	1/2"	2"	1 1/2" FAUCET: T&S BRASS B-865-4-W/ 122X RIGID GOOSE NECK, B-416 SWIVEL FITTING, 4" WRIST BLADES, 0.2 GPM. ANGLE STOP - MCGUIRE 2165. P-TRAP: MCGUIRE 8912I W/ ESCUTCHEON

ELECTRICAL SUMMARY

ELECTRICAL SYSTEM AND EQUIPMENT

METHOD OF COMPLIANCE:

Energy Code: ☒ Prescriptive ☐ Performance

ASHRAE 90.1: ☐ Prescriptive ☐ Performance

LIGHTING SCHEDULE (See each fixture type)

Lamp Type required in fixture	SEE SCHEDULE
Number of lamps in fixture	SEE SCHEDULE
Ballast type used in the fixture	SEE SCHEDULE
Number of ballasts in fixture	SEE SCHEDULE
Total wattage per fixture	SEE SCHEDULE
Total interior wattage specified vs. allowed (whole building or space by space)	N/A - ADDING LED TASK LIGHTING ONLY
Total exterior wattage specified vs. allowed	N/A

ADDITIONAL PERSPECTIVE COMPLIANCE

- ☐ 506.2.1 More efficient mechanical equipment
- ☐ 506.2.2 Reduced lighting power density
- ☐ 506.2.3 Energy recovery ventilation systems
- ☐ 506.2.4 Higher efficiency service water heating
- ☐ 506.2.5 On-site supply of renewable energy
- ☐ 506.2.6 Automatic daylighting control systems

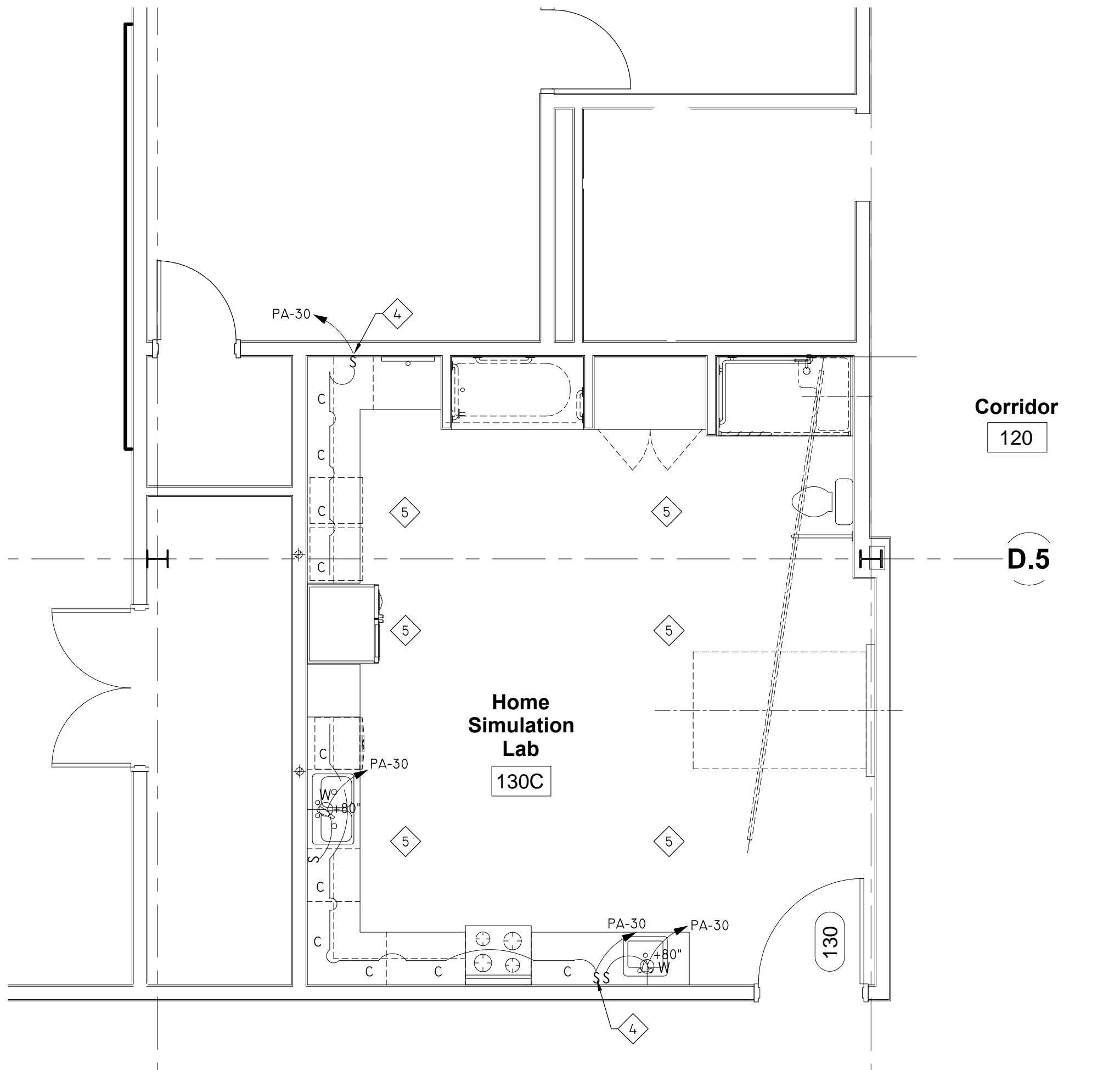

2 ELECTRICAL PLAN - LIGHTING
SCALE: 1/4" = 1'-0"

LIGHTING SCHEDULE					
SYMBOL	MOUNT	SIZE	VOLT	DESCRIPTION	LAMPS
	UNIV. MTD.	VARIES	120 TO 24V	LITHONIA CABINET LIGHT, LINKABLE STICK - LED, 24V, 18" LONG, STK19, 1.35W EA, 1/2" WIDE, 18 1/2" LONG. REQUIRES 24V STEP DOWN TRANSFORMER KIT	LED
	WALL MTD.		120	KICHLER LIGHTING DEAUVILLE I-LIGHT CHRHOME RECTANGLE LED VANITY LIGHT (SCONCE)	LED

ELECTRICAL GENERAL NOTES:

1. ALL ELECTRICAL DEVICES, FIXTURES, EQUIPMENT AND FEEDERS SHALL BE INSTALLED IN ACCORDANCE WITH THE PROJECT SPECIFICATIONS, THE MANUFACTURER'S RECOMMENDED INSTALLATION PROCEDURES, ALL APPLICABLE LOCAL AND STATE CODES, THE AMERICAN DISABILITIES ACT AND WITH THE LATEST EDITION OF THE NATIONAL ELECTRICAL CODE. ALL NEW DEVICE COVER PLATES SHALL BEAR IDENTIFICATION LABEL OF CIRCUIT NUMBER.
2. ALL CEILING FANS WILL BE LOCATED UNDER BEAMS. CEILING FAN BRACKETS TO BE PROVIDED BY PALMETTO OUTDOOR SPACES AND INSTALLED BY THE E.C.
3. WIRING TO BE MC CABLE, INSIDE HOLLOW ALUMINUM BEAMS.
4. ALL EXPOSED WIRING SHALL BE IN RIGID CONDUIT. ALL CONCEALED WIRING SHALL BE IN EMT AS SPECIFIED.
5. ALL PANELS SHALL HAVE TYPED, COMPLETED DIRECTORIES INDICATING EQUIPMENT SERVED AND ROOM NAME, OR SPARE, OR SPACE.
6. ALL FEEDERS AND CIRCUITRY SHALL BE TORQUED PER THE PANEL, BREAKER, AND/OR PARTICULAR EQUIPMENT MANUFACTURER'S SPECIFICATIONS. PANEL SHALL BE A SERVICE RATED ENTRANCE
7. CIRCUITRY TO SWITCHES, RECEPTACLES, AND ALL OTHER DEVICES SHALL BE TERMINATED TO DEVICE'S SCREW TERMINALS.
8. ALL POWER CIRCUITRY WIRING SHALL INCLUDE AN INSULATED EQUIPMENT GROUNDING CONDUCTOR SIZED PER THE NEC. WHERE PHASE CONDUCTORS ARE INCREASED IN SIZE DUE TO VOLTAGE DROP, HIGH AMBIENT TEMPERATURES, OR OTHER REASONS THE EQUIPMENT GROUNDING CONDUCTOR SHALL BE INCREASED PROPORTIONATELY PER THE NEC.
9. MOUNTING HEIGHTS INDICATED ARE TO CENTER OF DEVICE, OUTLET, FIXTURE, OR EQUIPMENT UNLESS NOTED OTHERWISE.
10. RECEPTACLES, TELECOMMUNICATION OUTLETS, AND OTHER DEVICES INDICATED MOUNTED 42" AFF OR 8" ABOVE COUNTER SHALL BE COORDINATED WITH PARTICULAR ADJACENT FIXTURES, EQUIPMENT, COUNTERS, AND CASEWORK FOR EXACT HEIGHTS AND LOCATIONS.
11. RECEPTACLES AND TELECOMMUNICATION OUTLETS SHOWN ADJACENT ON DRAWINGS SHALL BE MOUNTED 10" APART ON CENTER HORIZONTALLY.
12. COORDINATE ALL DEVICES AND OUTLETS ABOVE, BELOW, AND ABOUT CASEWORK CLOSELY WITH CASEWORK CONTRACTOR IN ORDER TO LOCATE AT THE PROPER LOCATION.
13. ALL FIXTURES, DEVICES, BOXES/ENCLOSURES, EQUIPMENT AND ALL OTHER ELECTRICAL COMPONENTS SHALL BE LISTED AND LABELED BY UNDERWRITER'S LABORATORIES (U.L.) OR ANOTHER THIRD PARTY LISTING AGENCY APPROVED BY THE KENTUCKY BUILDING CODE. U.L. CLASSIFIED WITH A BACKWARDS UR IS NOT SUITABLE. ALL ASSEMBLIES CONSISTING OF MORE THAN ONE COMPONENT IN AN ENCLOSURE SHALL BE LISTED AND LABELED AS AN ASSEMBLY.

the BOGLE FIRM
ARCHITECTURE
100 W. INNES ST SUITE 200A
SALISBURY, NC 28144
pete@boglefirm.com
www.boglefirm.com
704.796.1445 (mobile)
704.973.9413 (fax)
704.213.4553

PUBLICATION OR REUSE OF THESE DRAWINGS OR ANY INCLUDED DETAILS MUST BE WITH THE WRITTEN CONSENT OF THE FIRM'S PRINCIPAL ARCHITECT.

Basinger Design Co.
engineering | design | consulting
545 PLEASANT VILLAGE LANE
CHINA GROVE, N.C. 28023
BDC No: 16046
704.796.1445 (mobile)
704.973.9413 (fax)
james@bodedesignco.com

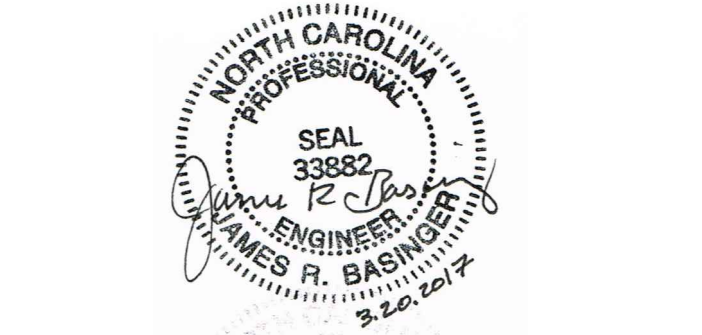

ELECTRICAL PLAN

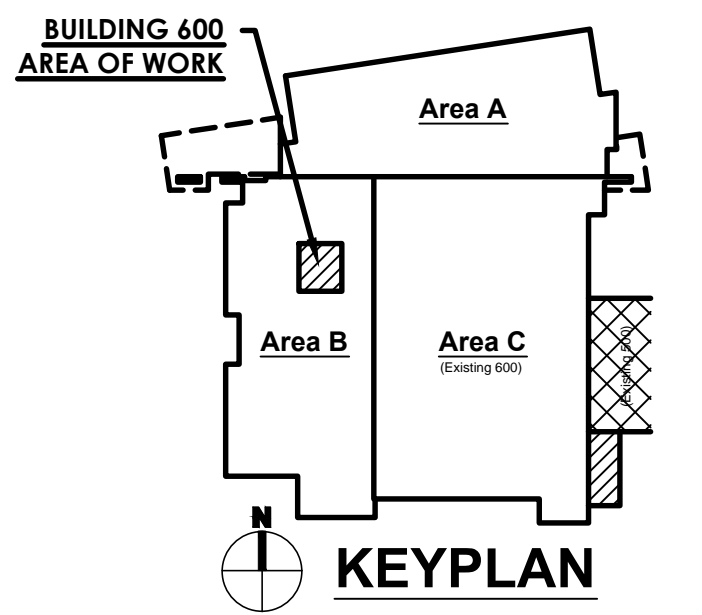

RCCC OTA HOME SIMULATION LAB

1333 JAKE ALEXANDER BLVD S
SALISBURY, NC

DRAWN BY: JRB
CHECKED BY: JRB
DATE: 03.20.17
PROJECT #: 1710

SHEET NUMBER
E1
OF: